

BALANDRA BY THE BAY

COME HOME TO THE COUNTRY



Contact

Balandra By The Bay 1 Limited [Maritime Financial Group](#)
Maritime Centre, 29 Tenth Avenue, Barataria, PO Box 710 Port of Spain, Trinidad West Indies
Tel. 868.674.0130 | Fax. 868.638.6663 | Email. info@balandrabay.com | www.balandrabay.com

Lesley J. Alfonso (Mrs) 868.674.0130 ext. 4030 Cell: 868.764.8800
Sharon Da Costa 868.674.0130 ext. 4004 Cell: 868.786.7711
Marcia Wellington 868.674.0130 ext. 4026 Cell: 868.785.3022

BALANDRA BY THE BAY

COME HOME TO THE COUNTRY



Private Paradise

Balandra by the Bay

Balandra by the Bay is an exclusive gated community located on the north east coast of Trinidad. This private paradise was created in the ideal environment for residents to experience the luxuries that life and nature have to offer.

Occupying over 35 acres in the lush hills of Balandra coast, we ensure that each parcel of land has it's own breathtaking view of the Atlantic Ocean.

This one of a kind residential development combines nature with modern day amenities, complete with 24hr security, its own private lake, safe for walking and jogging and nature trails with full access to one of the most beautiful and soothing beaches on the coast.

Whether your preference is country classic, beach cabin or simply contemporary you can bring your architectural design to life and make the country your home...

Contact

Lesley J. Alfonso (Mrs) 868.674.0130 ext. 4030 Cell: 868.764.8800
Sharon Da Costa 868.674.0130 ext. 4004 Cell: 868.786.7711
Marcia Wellington 868.674.0130 ext. 4026 Cell: 868.785.3022

Balandra By The Bay 1 Limited **Maritime Financial Group**
Maritime Centre, 29 Tenth Avenue, Barataria, PO Box 710 Port of Spain, Trinidad West Indies
Tel. 868.674.0130 | Fax. 868.638.6663 | Email. info@balandrabythebay.com | www.balandrabythebay.com

Where We Are.



Finding Paradise

Balandra by the Bay

Trinidad is located just off the coast of Venezuela, in the southern Caribbean. You'll find our private paradise on the north east coast of Trinidad, just minutes from the islands most favoured beaches by local and foreign surfers.

A long and refreshing drive from Piarco International Airport, heading east will take you past residential areas, through fishing villages and orchards, greeted by only smiling faces along the way.

Find Your Piece Of Paradise.

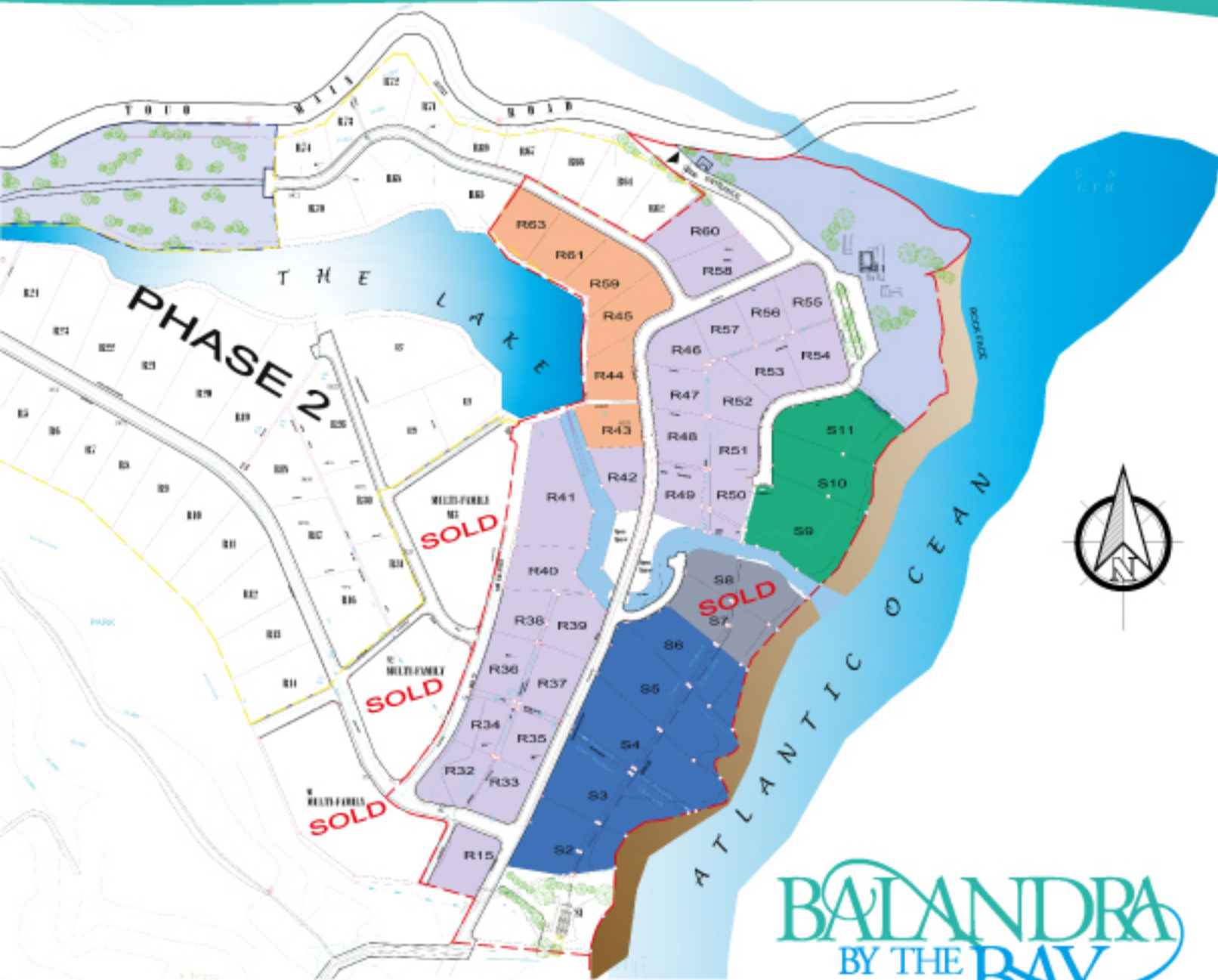

PHASE 1 LOTIFICATION PLAN: Site Areas

COME HOME TO THE COUNTRY

Beach Front		Lake Front / Beach View		Sea Front		Sea View									
LOT#	LOT AREA (m ² / ft ²)	LOT#	LOT AREA (m ² / ft ²)	LOT#	LOT AREA (m ² / ft ²)	LOT#	LOT AREA (m ² / ft ²)	LOT#	LOT AREA (m ² / ft ²)	LOT#	LOT AREA (m ² / ft ²)	LOT#	LOT AREA (m ² / ft ²)		
S9	4,403.2 (47,395.65)	R43	1,652.7 (17,769.51)	S2	3,385.1 (36,436.91)	R15	1,949.2 (20,981.01)	R37	1,781.5 (19,175.91)	R47	1,392.3 (14,986.59)	R53	1,538.2 (16,557.05)		
S10	2,752.6 (29,628.74)	R44	1,615.4 (17,388.02)	S3	4,098.1 (44,111.58)	R32	1,928.2 (20,754.97)	R38	1,340.4 (14,427.95)	R48	1,498.5 (16,129.72)	R48	1,498.5 (16,129.72)	R54	1,828.5 (19,681.81)
S11	3,153.4 (33,992.92)	R45	2,172.3 (23,382.44)	S4	4,531.6 (48,777.74)	R33	1,520.4 (16,355.45)	R39	1,783.6 (19,198.51)	R49	1,569.2 (16,890.73)	R49	1,569.2 (16,890.73)	R55	1,624.2 (17,482.74)
		R59	2,043.7 (21,998.2)	S5	4,937.4 (53,145.73)	R34	1,322.4 (14,234.2)	R40	1,811.7 (19,500.98)	R50	1,577.4 (16,978.99)	R50	1,577.4 (16,978.99)	R56	1,393.1 (14,995.2)
		R61	1,774.2 (19,097.33)	S6	3,451.8 (37,154.87)	R35	1,365.6 (14,699.2)	R41	2,763.5 (29,746.07)	R51	1,328.8 (14,303.08)	R51	1,328.8 (14,303.08)	R57	1,412.9 (15,208.33)
		R63	1,707.4 (18,378.3)			R36	1,608.7 (17,315.9)	R42	1,601.6 (17,239.48)	R52	1,681.3 (18,097.36)	R52	1,681.3 (18,097.36)	R58	2,011.8 (21,654.83)
								R46	1,523.3 (16,396.66)	R58	1,681.3 (18,097.36)	R58	1,681.3 (18,097.36)	R60	1,939.9 (20,890.91)

LEGEND

- WATER COURSE
- RESERVED AREAS
- BEACH FRONT
- SEA FRONT
- SEA VIEW
- LAKE FRONT / BEACH VIEW
- LOT BOUNDARIES
- PHASE 1 BOUNDARY
- PHASE 2 BOUNDARY
- ROAD RESERVE